

PROJECT WORK PLAN SHEET TWO
PROPOSED BULKHEAD AND DOCK IMPROVEMENTS
FULCHER POINT LLC SEAFOOD PROCESSING FACILITY
101 SOUTH AVENUE, ORIENTAL, NC
NUMBER FIVE TOWNSHIP, PAMLICO COUNTY
SEPTEMBER 12, 2017 SCALE: 1" = 50' (UNLESS NOTED OTHERWISE)

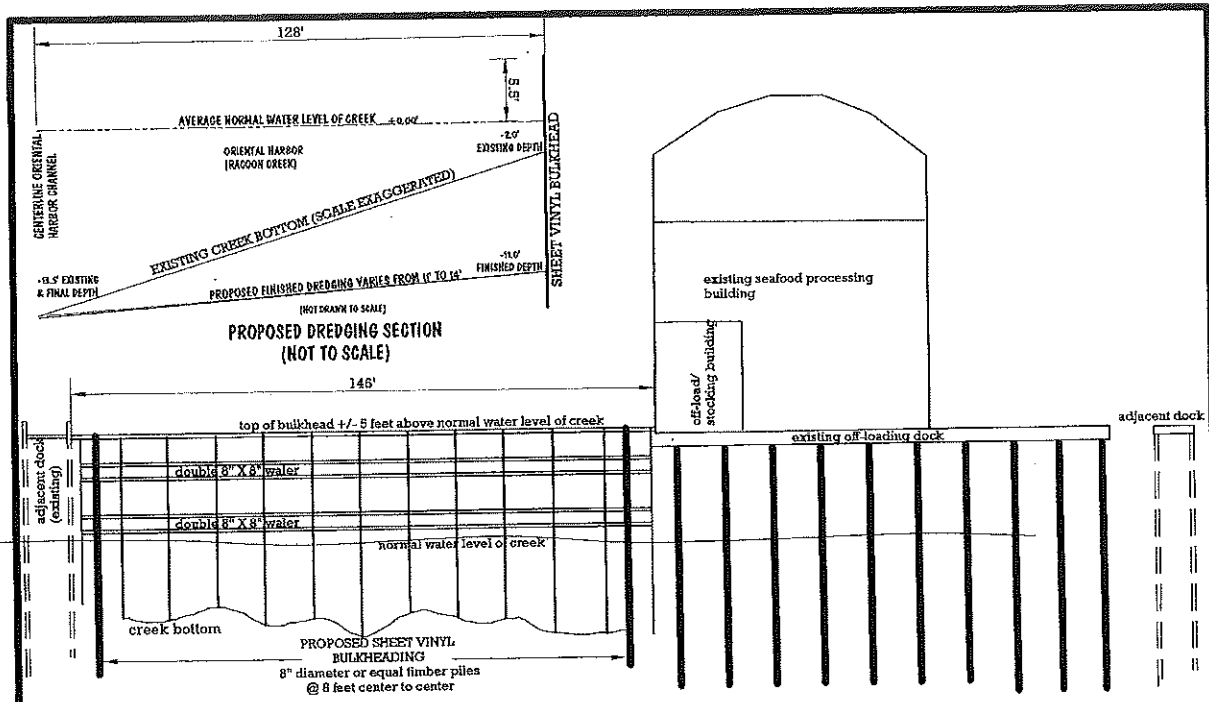

SHEET TWO OF THREE



Note: create enclosed cession between old bulkhead and new proposed bulkhead. Suction trapped creek water and marine life and backfill with sand loam and compact.

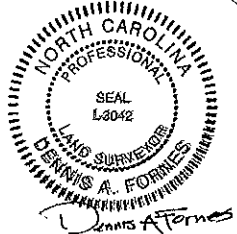
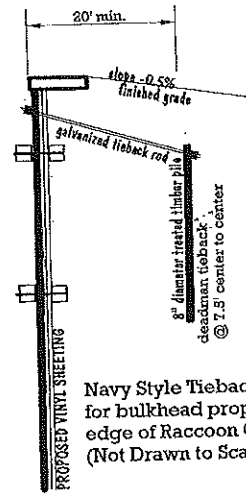
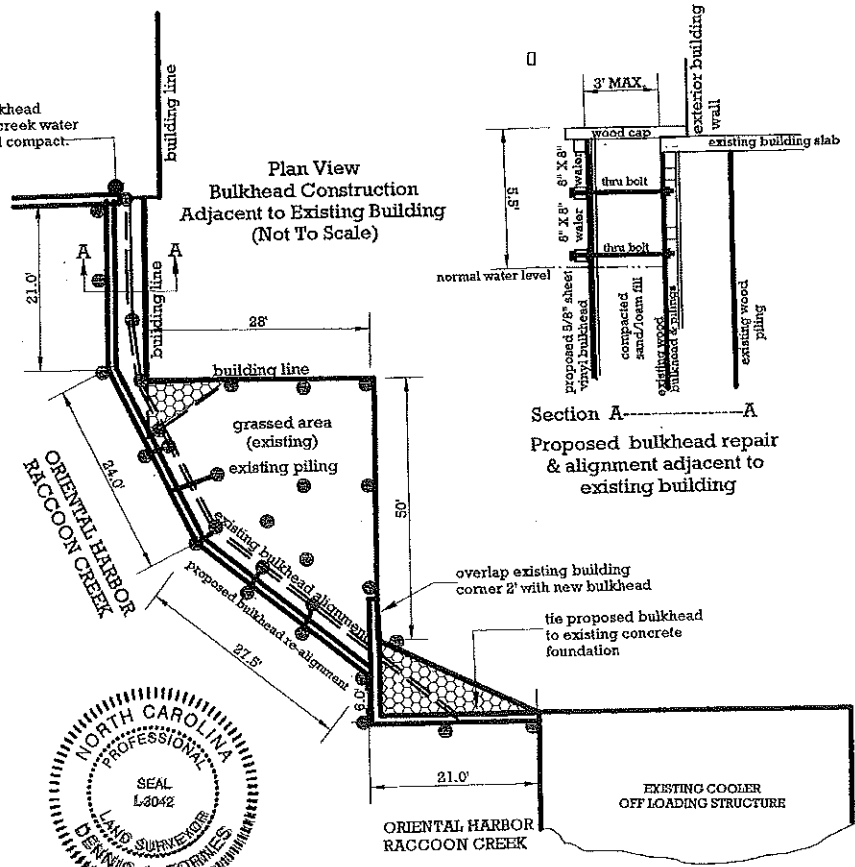

PRELIMINARY WORK PLAN SHEET 7 OF 8
 EXISTING SITE CONDITIONS
 PROPOSED BULKHEAD AND DOCK IMPROVEMENTS
 FULCHER POINT LLC SEAFOOD PROCESSING FACILITY
 101 SOUTH AVENUE, ORIENTAL, NC
 NUMBER FIVE TOWNSHIP, PAMLICO COUNTY
 SEPTEMBER 12, 2017 SCALE: 1" = 30' (UNLESS NOTED OTHERWISE)
 SHEET THREE OF THREE

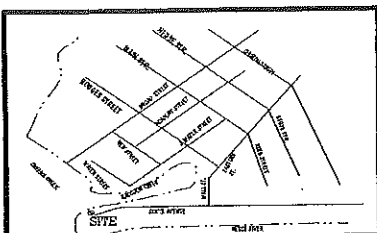

VICINITY MAP
(NOT TO SCALE)

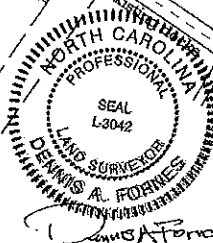
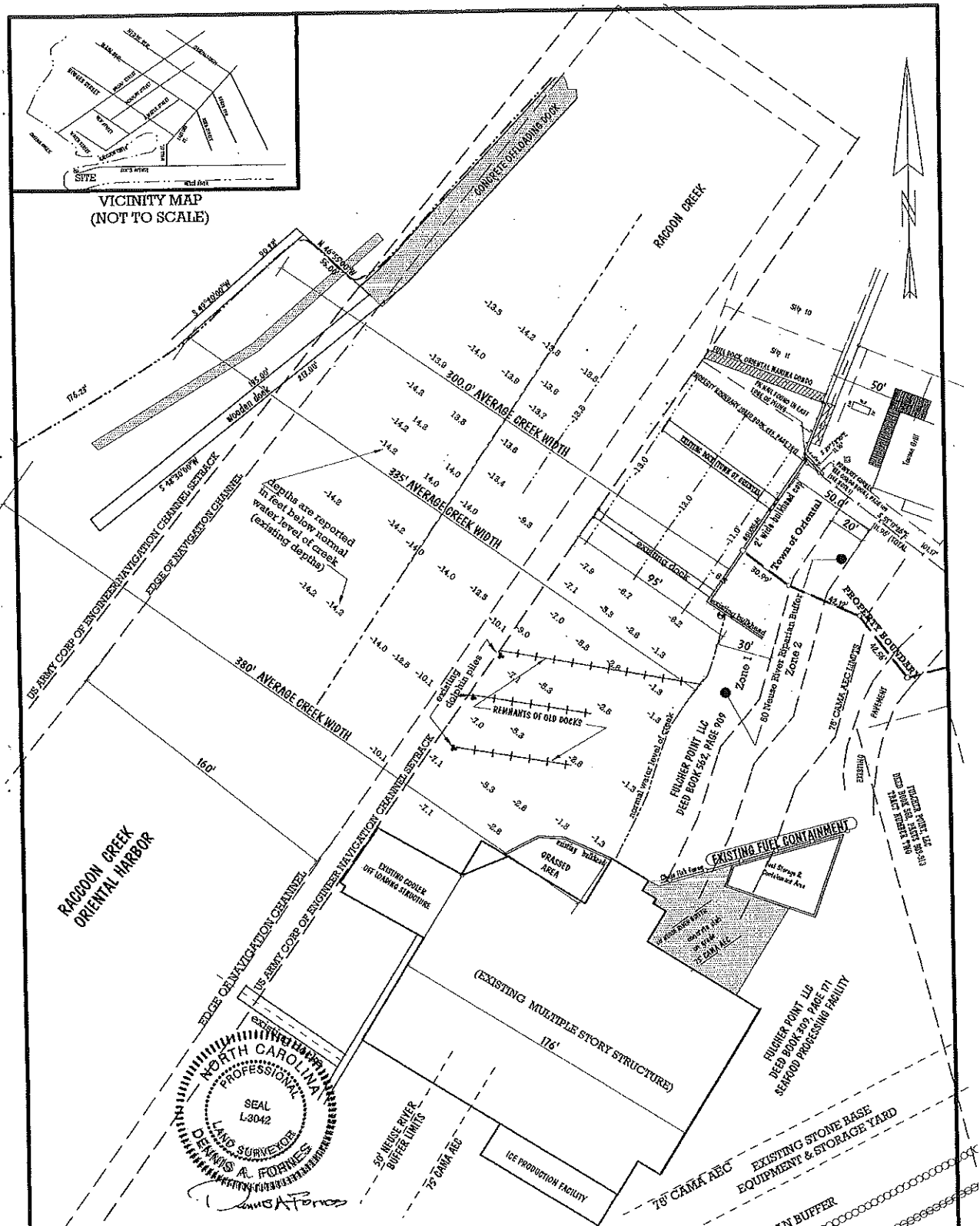

PROJECT WORK PLAN SHEET ONE OF THREE
 "EXISTING SITE CONDITIONS"
 PROPOSED BULKHEAD AND DOCK IMPROVEMENTS
 FULCHER POINT LLC SEAFOOD PROCESSING FACILITY
 101 SOUTH AVENUE, ORIENTAL, NC
 NUMBER FIVE TOWNSHIP, PAMLICO COUNTY
 SEPTEMBER 12, 2017 SCALE: 1" = 80' (UNLESS NOTED OTHERWISE)

